

# BARKER

# | SEMI-FLUSH MOUNT

# DVI<sup>®</sup> LIGHTING

SKU | DVP24711

## FINISH OPTIONS

Brass and Graphite with Clear Glass (BR+GR-CL)  
Satin Nickel and Graphite with Clear Glass (SN+GR-CL)



## DIMENSIONS

**Length / Ø:** 22.75"  
**Width:** N/A"  
**Height:** 6.5"  
**Depth:** N/A"  
**Minimum Height:** N/A"  
**Maximum Height:** N/A"

## LAMPING

**Number of Sockets:** 4  
**Wattage of Individual Socket:** 70W  
**Socket Type:** Medium Base (E26)  
**Socket Orientation:** Sideways  
**Lamp Confinement:** Semi Enclosed  
**Voltage:** 120V  
**Dimmable:** Yes  
**Bulbs Not Included**

## PIPE / CHAIN / CORD INFORMATION

**Pipe/Chain Kit Included:** Not Included  
**Pipe Information:** N/A  
**Chain Information:** N/A  
**Wire/Cord Information:** 8 Inches  
**Max Sloped Ceiling Angle:** N/A  
*\*Conversion 19° to 45° : ASY0101+Finish (2 loops + 1 chain):  
For Additional Cost*

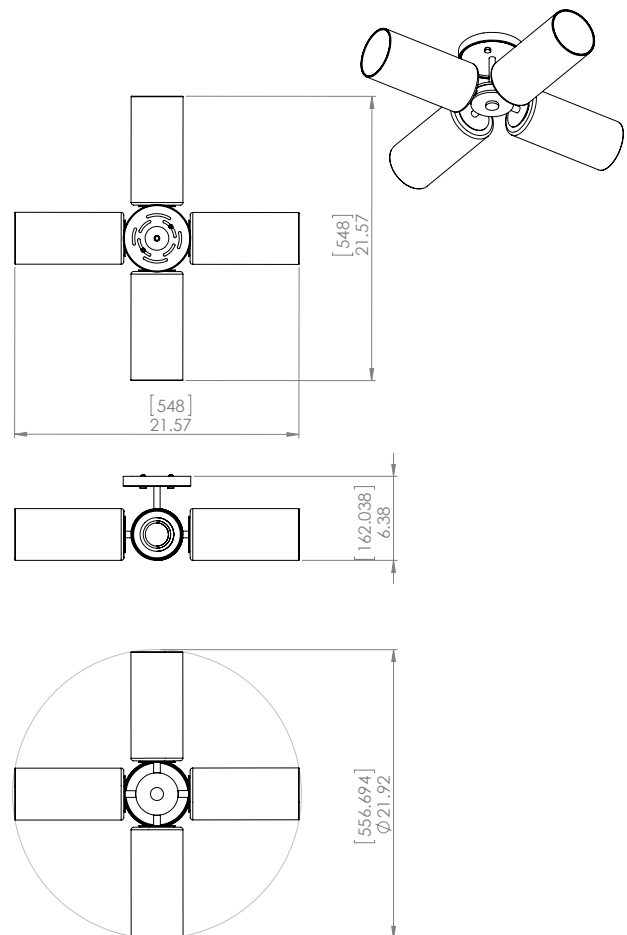

## ADDITIONAL INFORMATION

**Wall and Ceiling Mountable:** No  
**Up and Down Mountable:** N/A  
**Location Certification:** Dry Locations Only  
**ADA Compliant:** No

## WARRANTY

5 Years Residential  
20,000 Hours Commercial

120 Great Gulf Drive, Concord, ON L4K 5W1  
+1 855 384 5483 | +1 855 384 8453  
customerservice@dvi.lighting  
www.dvicanada.com